

① ADECUACIÓN MARCO SUPERIOR E INFERIOR

A) ADECUACIÓN MARCO SUPERIOR

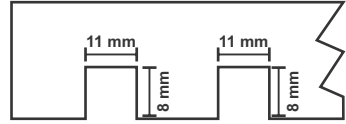

B) ADECUACIÓN MARCO INFERIOR

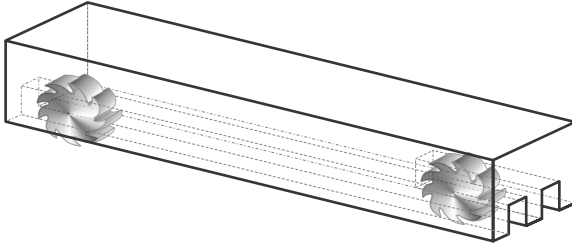
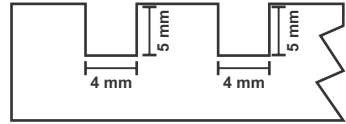
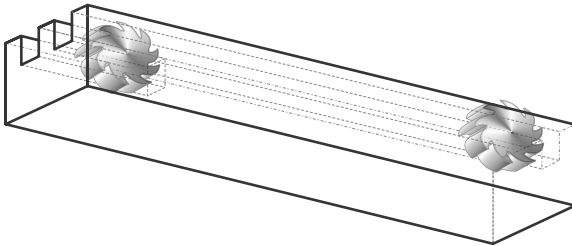

② INSTALACIÓN DE RIEL Y FRENO SUPERIOR

A) INSTALACIÓN RIEL Y FRENOS SUPERIORES

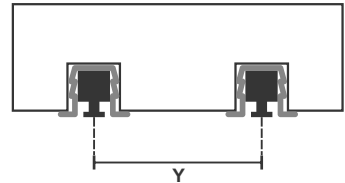
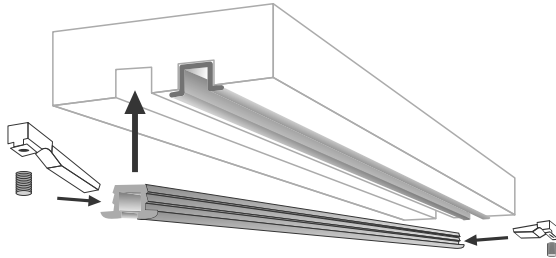

$$Y = \text{Ancho de la Puerta} + 5 \text{ mm}$$

② INSTALACIÓN DE RIEL INFERIOR

A) INSTALACIÓN RIELES INFERIORES

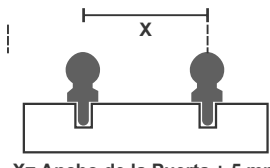
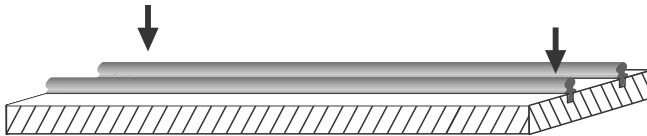

$$X = \text{Ancho de la Puerta} + 5 \text{ mm}$$

③ ADECUACIÓN DE LAS PUERTAS EN LA PARTE SUPERIOR E INFERIOR

A) ADECUACIÓN DE LAS PUERTAS EN LA PARTE SUPERIOR

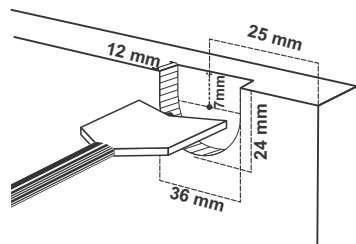
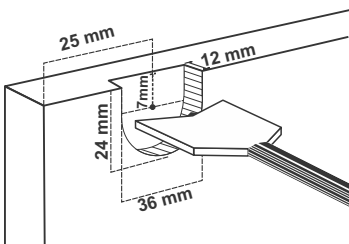

B) ADECUACIÓN DE LAS PUERTAS EN LA PARTE INFERIOR

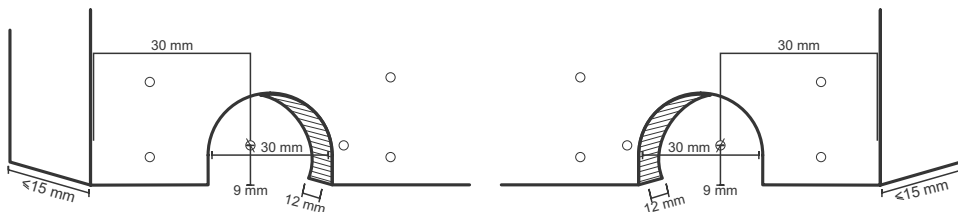

4) INSTALACIÓN DE PLATINAS Y RODACHINAS EN LAS PUERTAS

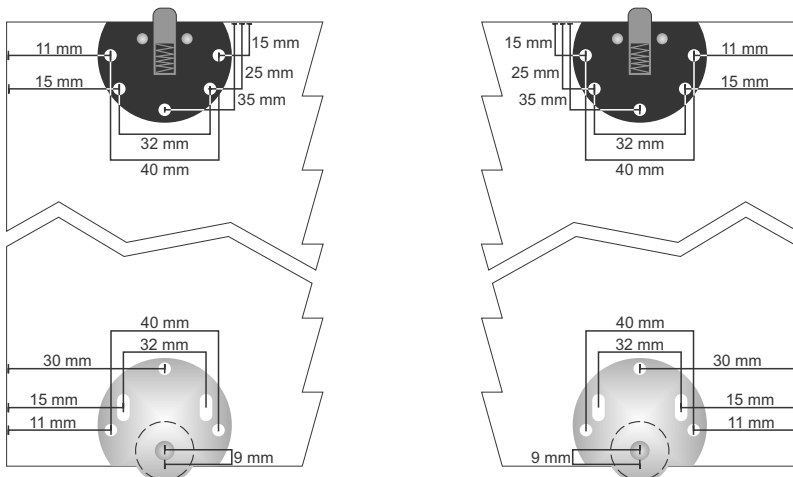

5) INSTALACIÓN DE PUERTAS EN LOS RIELES

A) INSTALACIÓN PUERTA INTERNA

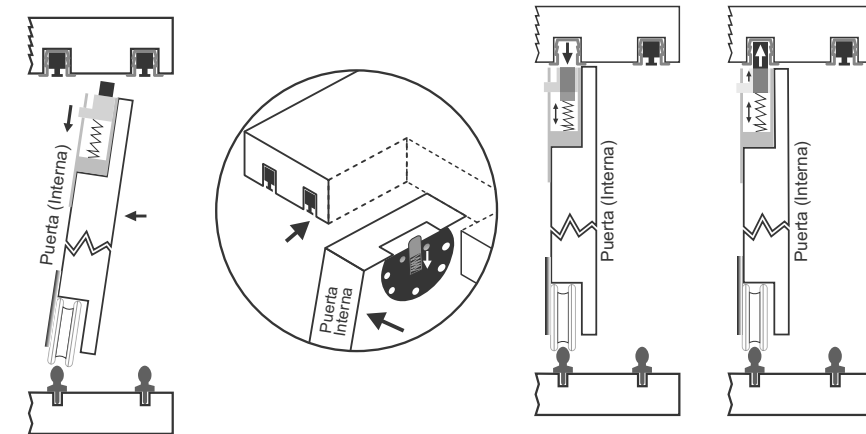

B) INSTALACIÓN PUERTA EXTERNA

